

Quick Possession



SOHO 2

SAVANNA

180 SAVANNA ROAD NE

\$352,900

1,214 ^{SQ}_{FT}

**3 BEDS
2.5 BATHS**

**STAINLESS STEEL
APPLIANCES**

**MOVE-IN
OCT. 2016**

**COLOUR SCHEME
#5 BAFFIN BAY**

SAVANNA
IN SADDLE RIDGE

SOHO 2
1,227 SQ FT

CARDEL
HOMES

FLOORPLAN

MAIN FLOOR | 603 SQ FT

UPPER FLOOR | 624 SQ FT

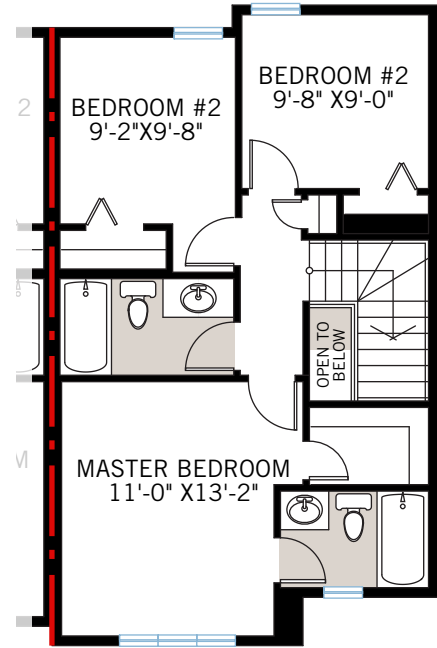
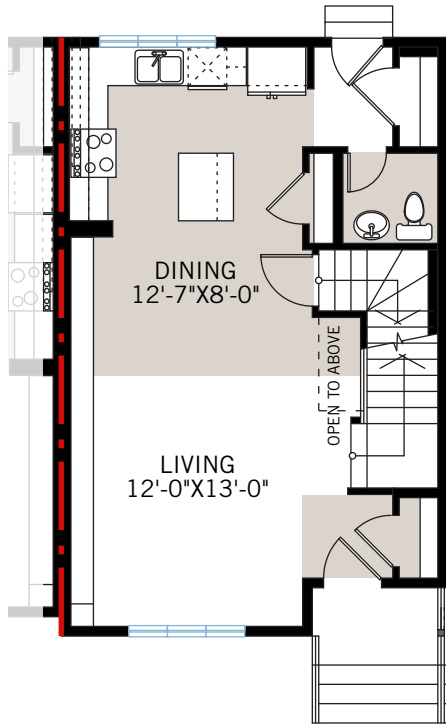

- Stainless steel appliances
- Granite kitchen countertops
- Hardwood/tile flooring
- 9' main floor ceiling

- Washer/dryer
- Front yard landscaping and irrigation
- South facing
- Near a playground/park area

SAVANNA
IN SADDLE RIDGE

SOHO 2 | 1,227 SQ FT

PLOT CONCEPT

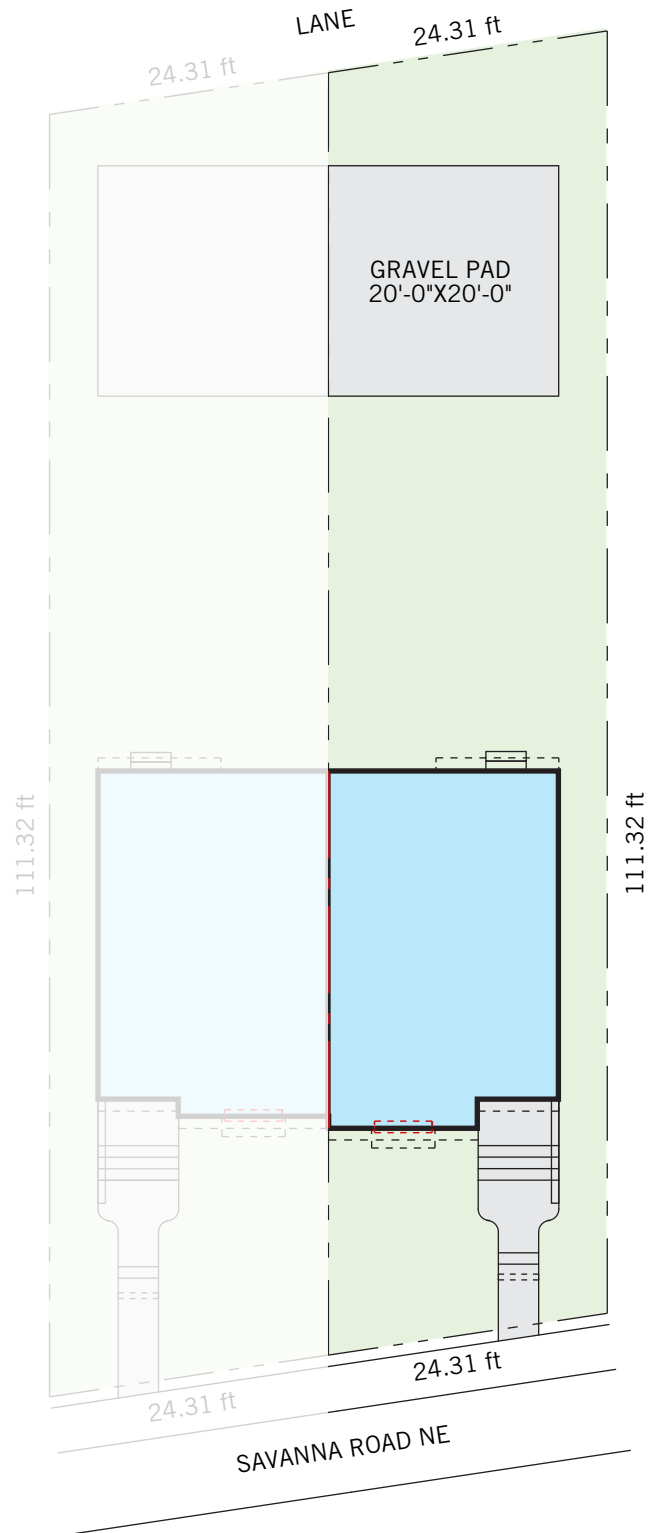

For more information contact:

Tabi Lam

Community Sales Manager

P: 403.454.6556

E: tabi.lam@cardelhomes.com

August 2016 | Actual plan and elevation may vary from brochure. Square footage is calculated using local Home Builder Association guidelines. This plan is published by Cardel Homes. Dimensions and square footage shown are approximate and subject to change without notice. All rights reserved including the rights of reproduction in whole or part without permission of Publisher E&OE. Please ask your sales manager for further information.

**CARDEL
HOMES**

REALLY WELL BUILT

COLOUR SCHEME



SCHEME 5 BAFFIN BAY

1. Kitchen Backsplash
2. Paint Colour
3. Laminate Floor
4. Cabinetry
5. Kitchen Countertop
6. Carpet
7. Bathroom Tile
8. Bathroom Countertop

Samples are for general reference only. Variations in shade, texture, dimension and colour may occur. Selections subject to availability. Fireplace tile is only applicable to select models.

SAVANNA
IN SADDLE RIDGE

SOHO 2
COLOUR SCHEME #5

CARDEL
HOMES