🕒 Quick Possession



ELEVATION A

THE ALDER

913 ORVIETO WAY (UNIT 1523)

**QUARTZ KITCHEN
COUNTERTOPS**

**UPPER FLOOR
LOFT**

**FINISHED BASEMENT
REC ROOM**

EdenWylde

2,256 SQ FT | 3 BED+LOFT | 2.5 BATH

**CARDEL
HOMES**

MAIN FLOOR

803 SQ FT

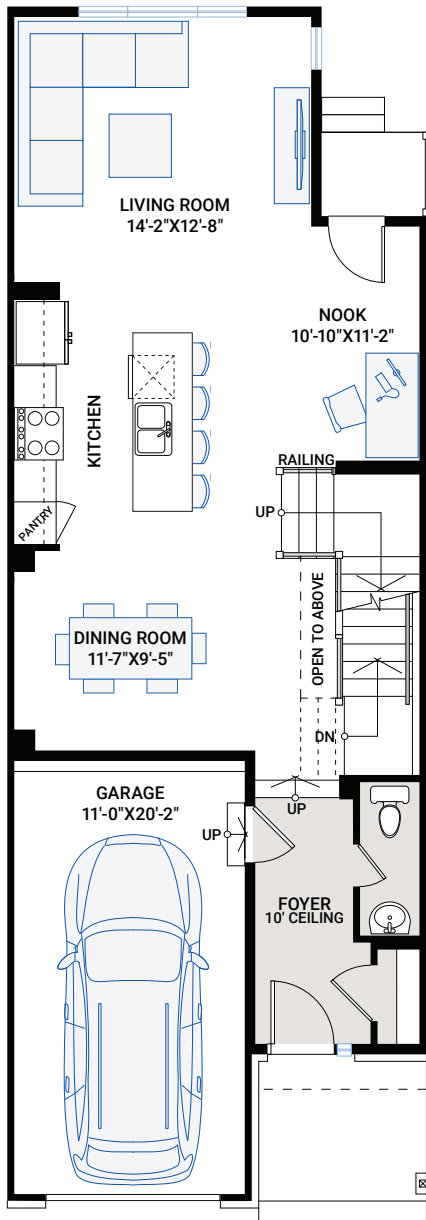

UPPER FLOOR

1,034 SQ FT

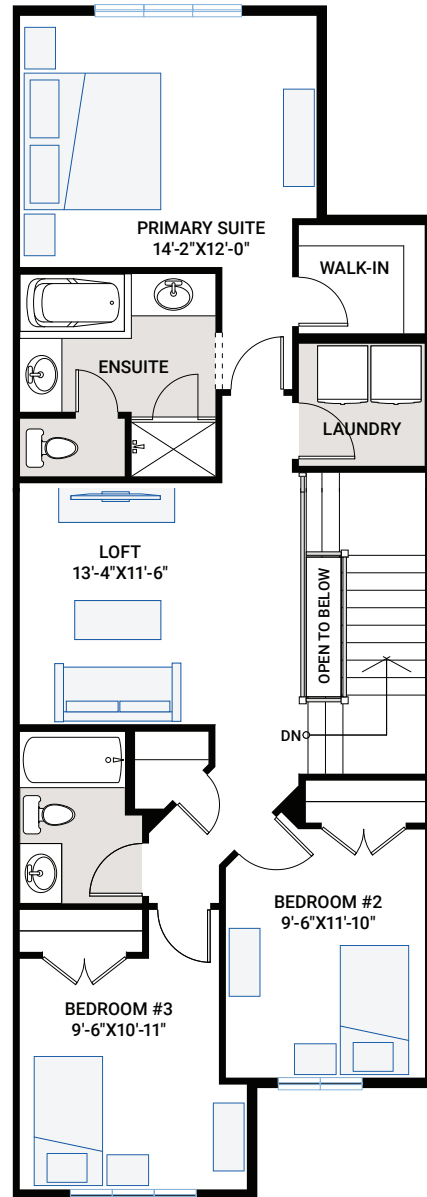

FOR MORE INFORMATION CONTACT: TAMMY CONDRAN Community Sales Consultant
tammy.condran@cardelhomes.com | P: 613.435.5704 | 511 EdenWylde Drive, Stittsville

BASEMENT

409 SQ FT

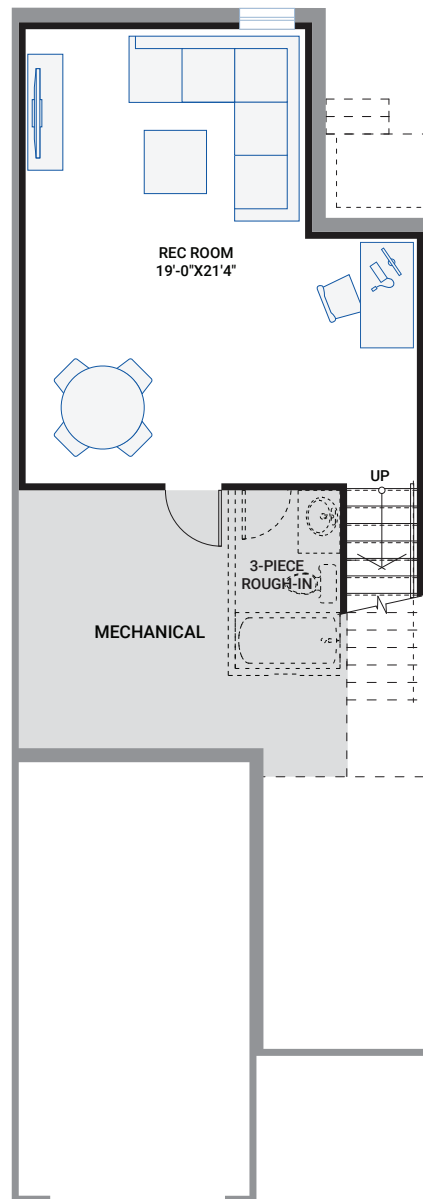

- Situated on a premium lot facing greenspace and a park
- Alternate kitchen with quartz countertops and upgraded cabinetry
- 3 stainless steel kitchen appliances and added waterline to fridge
- Upgraded hardwood throughout main floor (excludes wet areas)
- Alternate ensuite with double sinks and upgraded cabinetry
- Potlights in kitchen
- Convenient upper floor laundry
- A/C and humidifier included
- Finished basement rec room
- Designer selected interiors

INTERIOR COLOUR SCHEME – C



* All sizes are nominal. The colours represented on this page may vary from the actual product colours. Actual samples can be viewed by appointment.