Quick Move-In



CANADIANA A1

Exterior colours may vary.

THE PAXON

749 KENNY GORDON AVE (LOT 51)

**FOURTH BEDROOM
SUITE**

**QUARTZ
COUNTERTOPS
THROUGHOUT**

**DESIGNER SELECTED
INTERIORS**

MAIN FLOOR

1,067 SQ FT

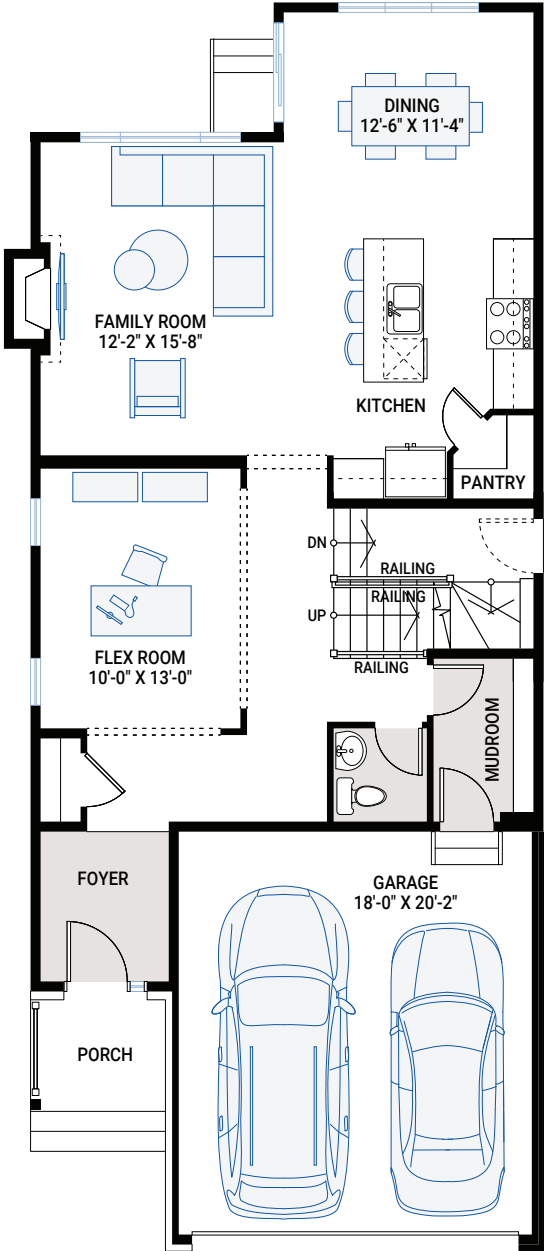

FOR MORE INFORMATION CONTACT VIVIEN TARNAI New Home Consultant
P: 343.999.2556 | Vivien.Tarnai@cardelhomes.com



2,336 SQ FT | 4 BED | 3.5 BATH



UPPER FLOOR

1,229 SQ FT

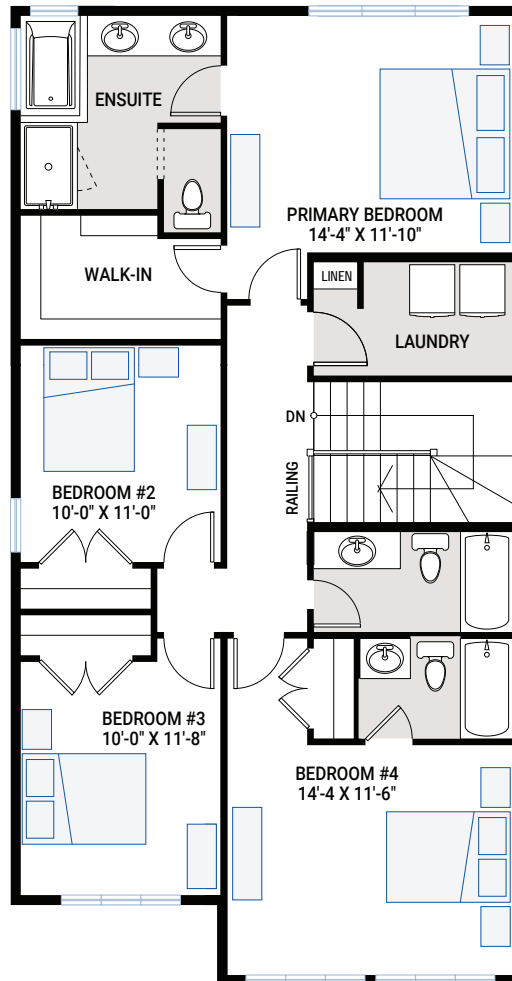

- Open-concept main floor with gas fireplace, boasting with natural light
- Upgraded kitchen cabinetry with stainless steel chimney hood fan
- Quartz countertops throughout
- 9' smooth ceilings on main floor
- Large main floor flex room, perfect for formal dining or office
- Enlarged windows added to family room and primary bedroom
- Upgraded pulldown black faucet in kitchen
- Upgraded black interior doorknobs throughout
- Upgraded hardwood throughout main floor (excluding wet areas)
- Upgraded tile in wet areas
- Luxurious ensuite bathroom including oversized vanity with 2 sinks and soaker tub
- Oversized 4th bedroom with personal 3-piece bathroom on the upper floor
- Convenient upper floor laundry room with window
- Developed basement stairs
- Separate exterior side entry to basement stairs
- 3-piece rough-in for future basement bathroom
- Designer selected interiors

INTERIOR COLOUR SCHEME – 5B



* All sizes are nominal. The colours represented on this page may vary from the actual product colours. Actual samples can be viewed by appointment.